



PRESSALIT®



R1192
R1193
R1194
R1195

TMA 3

Arm support – Operation and maintenance manual

en





Pressalit's Environmental and Quality Management Systems are certified by LRQA

en The warranty covers faults or defects in the material of our products within a period of 3 years from date of invoice. Products subject to minor technical modifications and design deviations E. & O.E.

REF



R1192,
R1195 (AU)

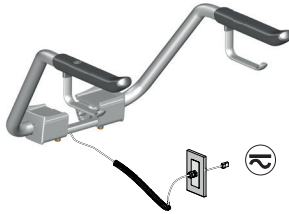

R1193 (AU)

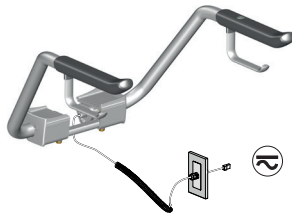

R1194 (AU)

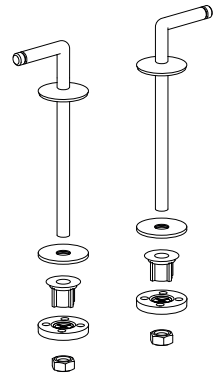
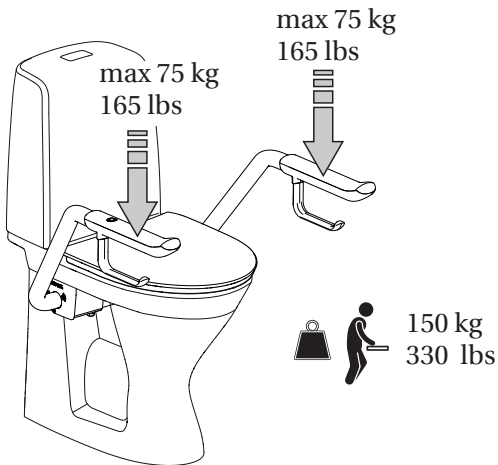

BD1

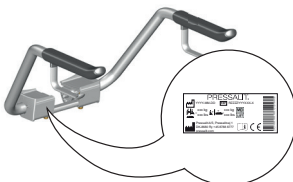

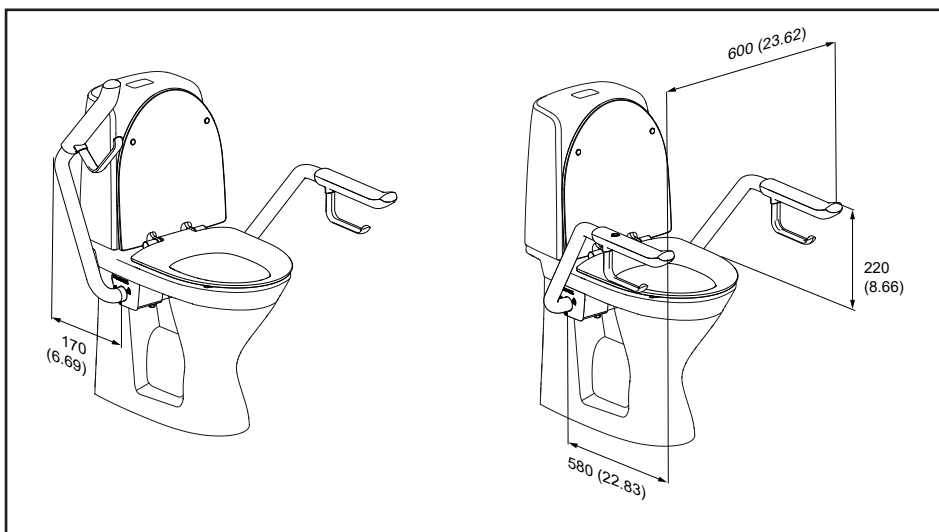
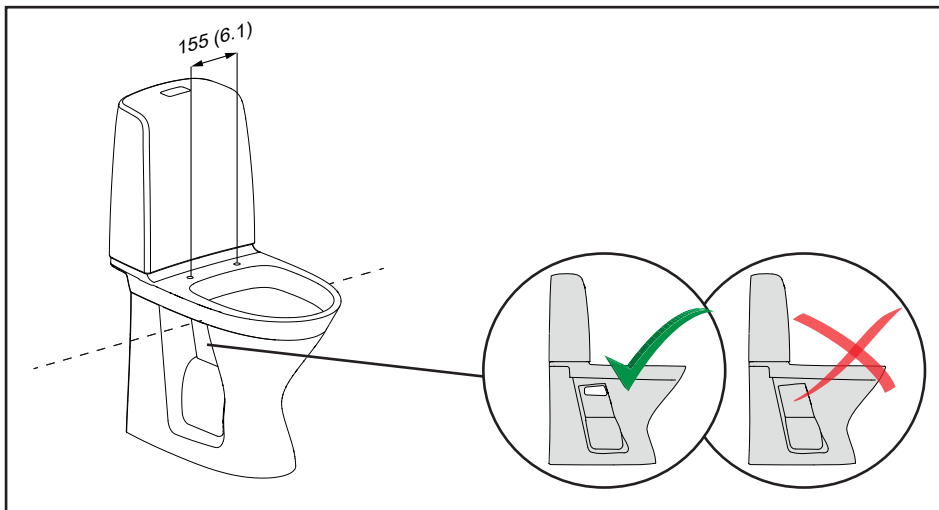

	Max P	U	Max I
R1193	4 W	40 V	0.1 A
R1194			

Content

Mounting instruction	5
Symbols used in this manual	6
General safety	7
Intended use	8
Intended user profile	8
Operating environment	8
Operating instructions	9
Nurse call button	9
Adjustment	9
Maintenance	10
Maintenance inspection	10
Cleaning	11
Trouble-shooting	11
Product label	12
Technical data	14
Disposal and recycling	14

en

Mounting instruction



A mounting instruction is included with the product. It can also be downloaded from pressalit.com.



Test the load-bearing capacity of the floor before installation. Floor-standing WC ceramic appliances must be securely fixed to the floor with screws.

Original instructions

Symbols used in this manual

The following symbols are used in this manual as well as the associated documentation supplied with the product.



WARNING indicates a potentially hazardous situation which, if not avoided, could result in death or serious injury.



CAUTION indicates a potentially hazardous situation which, if not avoided, may result in minor or moderate injury. It may also be used to alert against unsafe practices.



IMPORTANT indicates important information about handling and use of the product.



NOTICE is used to address practices not related to personal safety.



Hand injury warning



Product weight



Max. user weight



Article number/
versions

General safety

WARNING

- Read and understand the manual completely before use. Keep the manual close to the unit.
- Comply with this manual to avoid accidents involving serious personal injury.
- Never use or handle this product in other ways than specified in this manual, as this can put your safety at risk and cause damage to the product.
- Make sure that everyone who is to install or use the product and its systems has the necessary information and access to this manual.

CAUTION

- Please comply with these instructions to avoid the product becoming damaged or destroyed.
- Do not perform repairs, disassembly, or assembly operations, extensions, re-adjustments or modifications to this product. These must be carried out by Pressalit or by persons authorized by Pressalit only.
- Never allow children to operate this product unless under supervision. The product is not intended for play.
- Never use the product if it is defective or damaged. Do not use a defective product before it has been repaired.

NOTICE

- The information in this manual is based on correct fitting of the product in accordance with our mounting instruction.
- Pressalit cannot be held liable if the product is used in any way which differs from that described in the guide.
- We reserve the right to amend this manual without prior notice.

Intended use

The arm support is used as support for a person when he or she sits down or gets up from a toilet.

Intended user profile

The product can be used by everyone - adults, children, teenagers, and the elderly who need support when getting up or sitting down on the toilet.

Operating environment

For indoor use in a wet environment, such as a bathroom or wash room, in private homes, nursing homes and hospitals. For institutional use, the expected life time is 10 years.

Life cycle test performed according to ISO 17966:2016.



The surface of the product may become hot and/or cold if exposed to external sources of heat or cold (e.g. sunlight or frost).



Fire hazard. Keep open flame away from the grey handles.



Any serious incident that has occurred in relation to the product should be reported to Pressalit and the health authorities.

A serious incident is defined as an incident that leads to the death of a patient, user, or any other person, or causes a temporary or permanent deterioration in the person's health. Any incident that has resulted in or has the potential to result in a serious incident must be reported.

Operating instructions

The two arm supports can be folded up and down individually. Fold them both up when not in use.

	<p>Take care to avoid injury to hands when in the vicinity of closing moveable parts.</p>
--	--

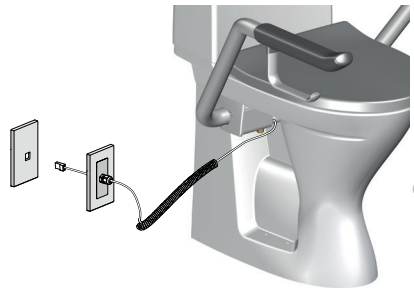

Nurse call button

The support arm models R1193 and R1194 are equipped with a nurse call button on either left or right arm. Press the button to call for help. The button must be connected to a call system.

Adjustment

With the three screws you can adjust how tight the movement of the support arms should be.

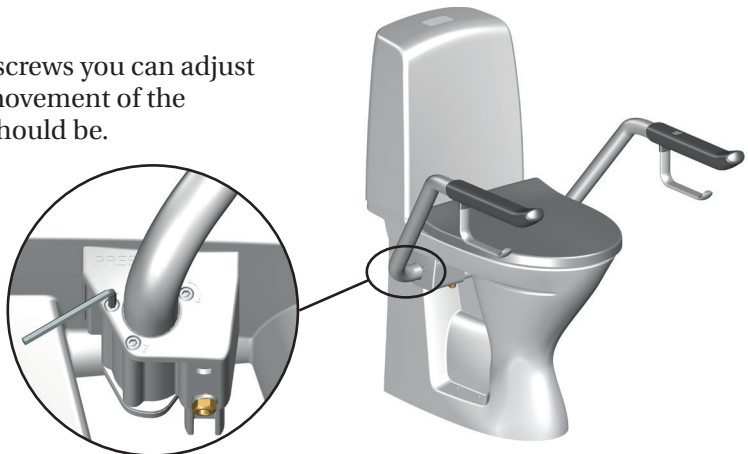

en

Maintenance

It is recommended that maintenance inspection is done once a year.

Maintenance inspection

Tighten the screws ① if necessary.

Do not use hinges other than the original ones.

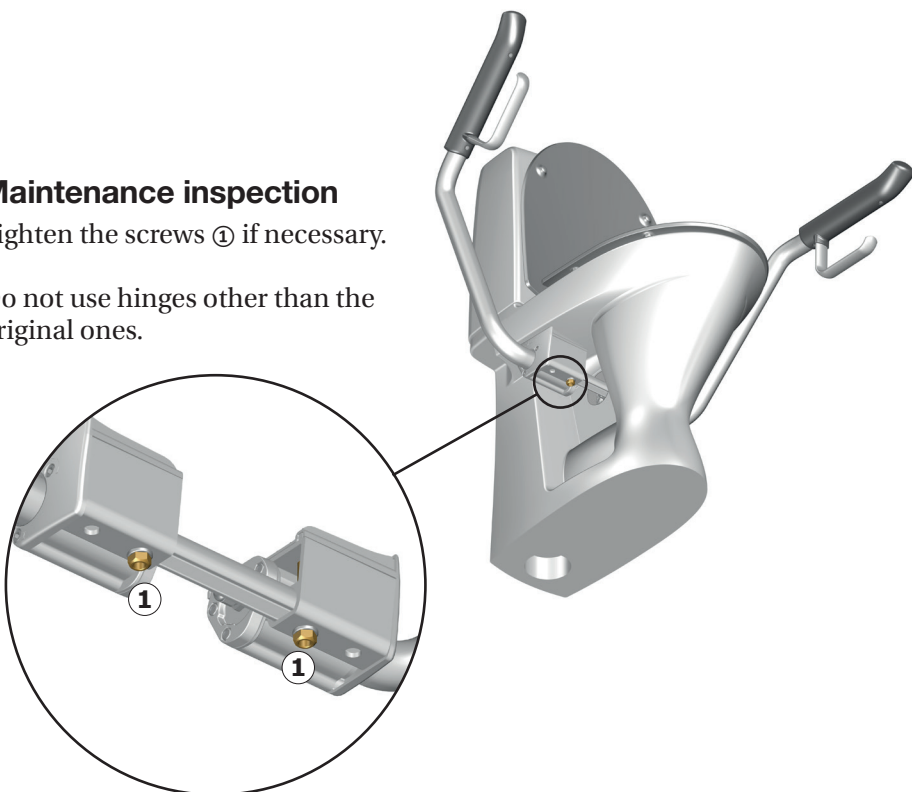

CAUTION

- Do not use the product if it is broken or damaged.
- Do not repair items not described under maintenance.

Cleaning

The product is to be cleaned with hot water or a mild soapy cleaning agent. To see which cleaning products have been tested and approved by Pressalit for the specific product, please visit Pressalit.com and refer to the product's item number. Pressalit recommends cleaning the product after installation.

CAUTION

Always read the material safety data sheet (MSDS) and supplied instructions of the cleaning, disinfecting or de-scaling agent and comply with instructions for safe use, dilution, rinsing, drying, handling and storage of the agent.

IMPORTANT

- Do not use an autoclave or other type of steam cleaner.
- Avoid aggressive cleaning agents containing acids.
- Never spray the product directly with a high pressure cleaner.
- Avoid use of abrasive, corrosive or chlorine-based cleaning or disinfecting products.

en

Trouble-shooting

Symptom	Cause	Action
The call button does not work.	The plug for the button has been pulled out.	Put the plug back into the socket.
The support arms drop down to fast.	The adjustment screws are too loose.	Tighten the three adjustment screws. See "Adjustment".
The support arms are loose/unstable.	The mounting screws have become loose.	Tighten the mounting screws. See "Maintenance".

Product label

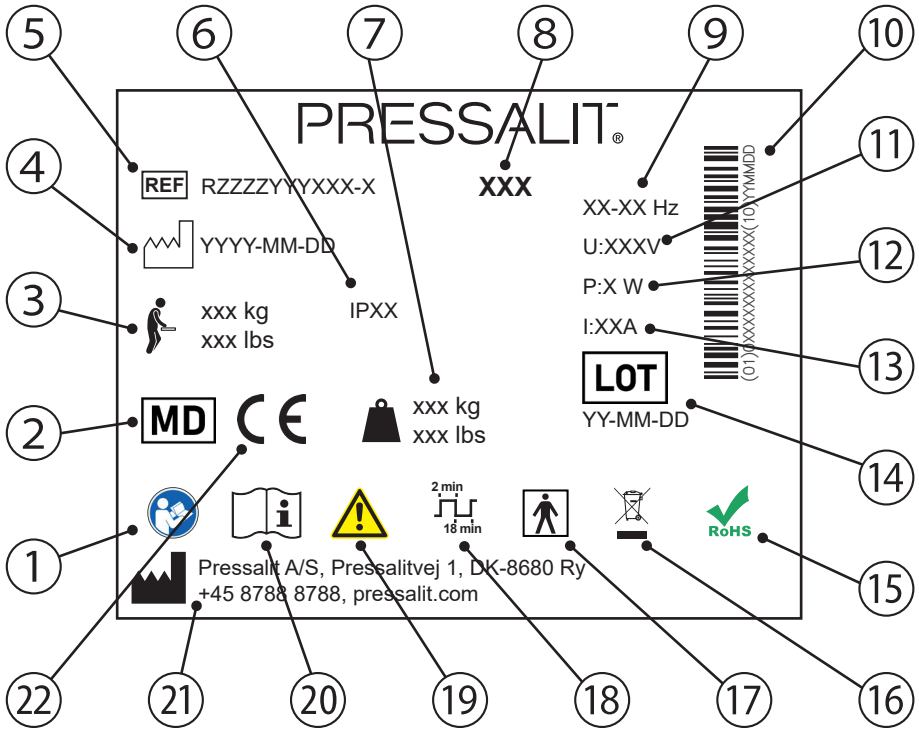

① Consult manual for use

② Medical device

③ Maximum user weight

④ Date of manufacture

⑤ Article number

⑥ IP class

⑦ Product weight

⑧ Product name

⑨ Frequency

⑩ UDI carrier GS1-128 barcode

⑪ Mains voltage

⑫ Maximum power consumption

⑬ Electric Current

⑭ Batch code

⑮ This product does not contain any of the hazardous substances mentioned in the Council Directive 2011/65/EC on RoHS.

⑯ Do not dispose as unsorted municipal waste The product should be collected separately and returned to the designated recycling service.

⑰ Type BF applied part Part of the product in normal use necessarily comes into physical contact with the patient to perform its function The product complies with requirements of IEC 60601-1 to provide protection against electric shock.

⑱ Duty cycle

⑲ Consult the manual for important cautionary information such as warnings and precautions.

⑳ Consult manual for use.

㉑ Name and address of manufacturer.

These products are CE-marked in accordance with relevant requirements in:

- ㉒
- Regulation (EU) 2017/745 (5 April 2017) on medical devices
 - Council Directive 2006/42/EC (of 17 May 2006) on machinery
 - Council Directive 2011/65/EC (of 8 June 2011) on RoHS

A declaration of conformity can be found at pressalit.com.

Technical data

Materials	Aluminium Polyurethane
IP class	IPX6
Operating temperature	-30°C – +80°C (-22°F - 176°F)

Disposal and recycling

The unit contains reusable materials. There are no known hazards or risks associated with disposal of the product. All components can be discarded after having been cleaned and disinfected.

When disposing of the product, we recommend that it be disassembled and broken down into different waste groups for recycling or combustion.

The following table provides information on the recycling and handling of the product.

Aluminium	Aluminium is theoretically 100% recyclable without any loss of its natural qualities. It requires only 5% of the energy used to produce primary aluminium. The quality of recycled aluminium is so high that it can be used again and again, even in the case of anodised products as the anodised layer is a natural part of the aluminium.
Polyurethane	Like other plastics, polyurethane can be recycled in two primary ways: mechanical recycling, in which the material is reused in its polymer form, and chemical recycling that takes the material back to its various chemical constituents.

Pressalit A/S
Pressalitvej 1
8680 Ry
Denmark
Tel. : +45 8788 8788
Fax : +45 8788 8789
E-mail : pressalit@pressalit.com

PRESSALIT®

pressalit.com

en Visit our website to find your local dealer and get further information about Pressalit and our solutions for bathrooms and kitchens.

